

Plan of Ground Floor 1:50

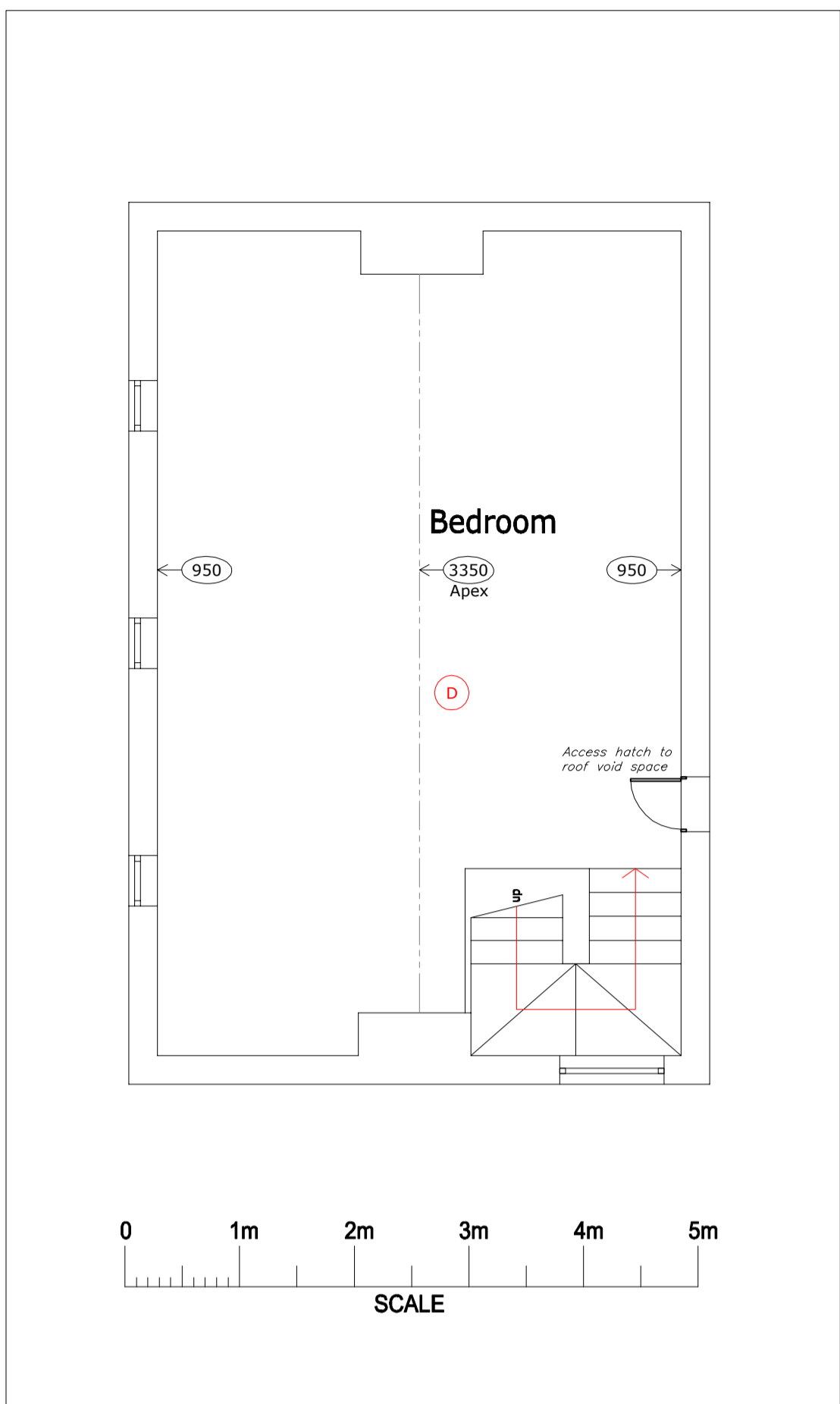

Plan of Second Floor 1:50



Plan of First Floor 1:50

LEGEND

- Fire Alarm Panel
- Automatic fire detector
- Manual Call Point
- Sounder
- Sounder Beacon
- Emergency Light (Fluorescent or LED)
- Emergency Exit Light (C/W Legend)
- Wet Chemical fire extinguisher
- 5 litre water fire extinguisher
- Dry powder fire extinguisher
- Carbon dioxide fire extinguisher
- Foam fire extinguisher
- CCTV camera
- Mechanical extraction fan
- Air conditioning unit

Rev:	Note:	Date:
-	-	-

- 1.0 GENERAL NOTES**
- 1.1 THIS INFORMATION IS NOT INTENDED TO PROVIDE A FULL SPECIFICATION OF WORKS & SHOULD BE READ IN CONJUNCTION WITH A SURVEY, SCHEME DRAWINGS & TENDER DOCUMENT.
 - 1.2 ALL WORKS TO COMPLY WITH CURRENT BUILDING REGULATIONS & LOCAL AUTHORITY REQUIREMENTS.
 - 1.3 ELECTRICAL INSTALLATIONS MUST COMPLY WITH IEE 16TH EDITION REGULATIONS FOR THE ELECTRICAL EQUIPMENT OF BUILDINGS & WIRING REGS.
 - 1.4 ALL WALLS & CEILING SURFACES: CLASS 1 SPREAD OF FLAME RATING TO BS 476 PART 1, EXCEPT FOR CIRCULATION SPACES WHICH ARE CLASS 0 RATING.
 - 1.5 DIMENSIONS TO BE CHECKED ON SITE.
 - 1.6 ANY FURTHER INFORMATION OF QUERIES ARISING FROM THIS DRAWING SHOULD BE ADDRESSED TO 2C design

Project Title:
Portsmouth Hoy
LAYOUT OF PROPERTY FLOORS

Project Address: The Quay Poole Dorset BH15 1HJ	Drawing Number: 2CD01396-FP	Rev: -	Paper Size: A1
Sheet No: 1 of 1	Date: 23.04.13	Scale UoI: 1:50	



2C Design Consultants Ltd
The Design Hub
Puma Way
Coventry CV1 2TT
tel: 0870-850-8330
fax: 02476-792-218
www.2Cdesign.co.uk