

**NOTE:**  
 The Contractor is to check and verify all building and site dimensions, levels and sewer invert levels at connection points before work starts.  
 This drawing must be read with and checked against any structural or other specialist drawings provided.  
 The Contractor is to comply in all respects with the current Building Regulations whether or not specifically stated on these drawings.  
 The drawing is not intended to show details of foundation or ground conditions. Each area of ground relied upon to support the structure depicted must be investigated by the Contractor and suitable methods of foundation be proposed.

**LEGEND**

|                 |  |
|-----------------|--|
| FD              | Fire Rated Doorset                           |
|                 | Feature and fittings                         |
|                 | Cigarette Venting                            |
|                 | Cip. Vent                                    |
|                 | Telephone                                    |
|                 | Games Machine (ANY or STBY)                  |
|                 | Pool Table                                   |
| <b>Services</b> |  |
|                 | Fire Alarm Panel                             |
|                 | Automatic fire detector                      |
|                 | Manual Call Point                            |
|                 | Sounder Beason                               |
|                 | Emergency Lighting (or luminance) (sw/night) |
|                 | Emergency Exit Light (C/W legend direction)  |
|                 | 9 litres water fire extinguisher             |
|                 | Dry powder fire extinguisher                 |
|                 | Carbon dioxide fire extinguisher             |
|                 | Foam fire extinguisher                       |
|                 | CCTV camera                                  |
|                 | Mechanical extraction fan                    |
|                 | Air-conditioning unit                        |

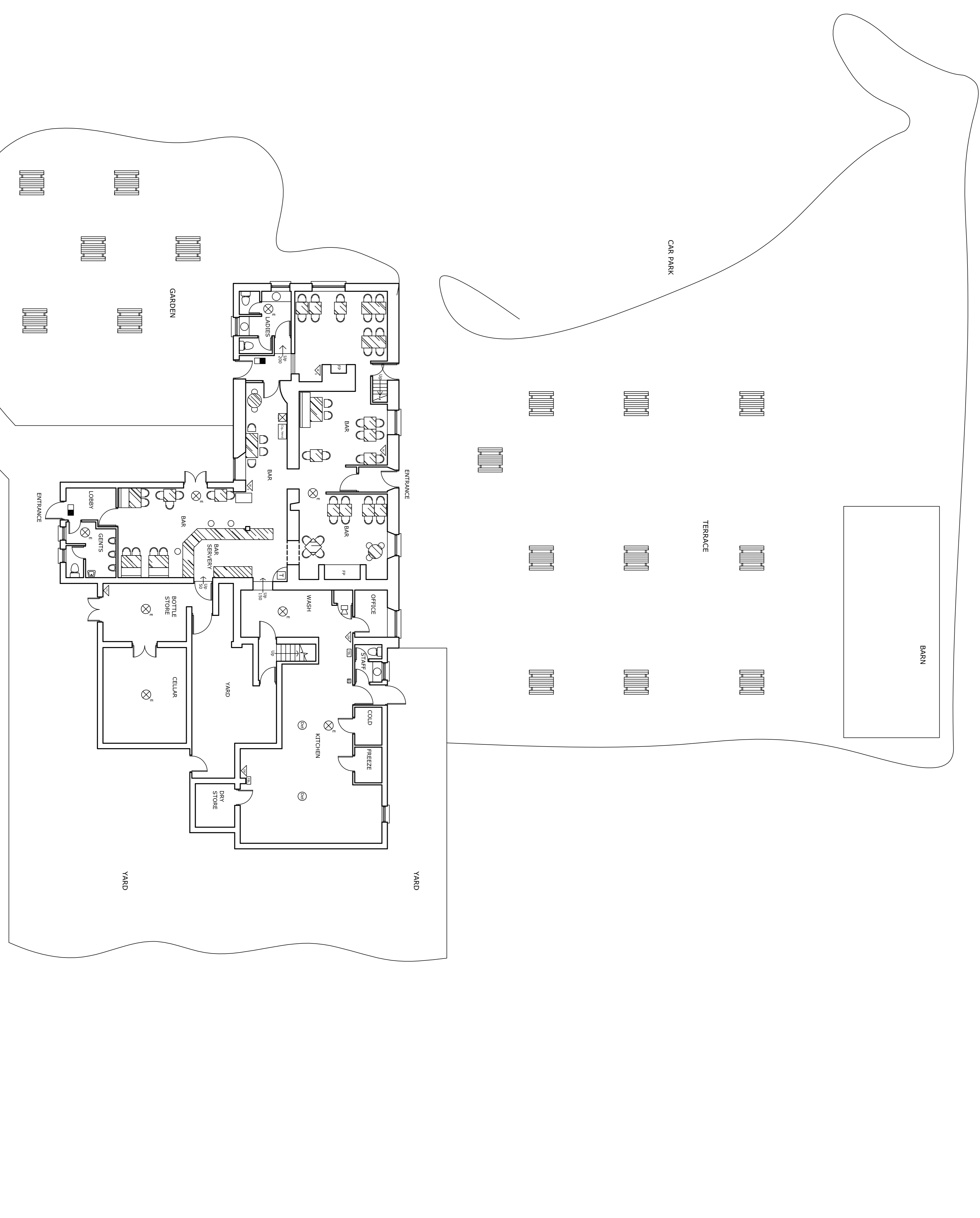

|                        |      |                |              |       |          |      |         |
|------------------------|------|----------------|--------------|-------|----------|------|---------|
| Project Manager/Client | FC   | Drawn By       | AK           | Scale | 1:100@A1 | Date | 29/4/05 |
| Arch./Dra.             | ROSE | Drawing Number | 6072/4121/01 |       |          |      |         |

**Effective Drinking Area = 86 sq. m.**

|            |   |
|------------|---|
| Client     | Hall & Woodhouse  |
| Site       | The Halfway Inn<br>Norden, Nr Corfe Castle<br>Wareham, Dorset |
| House code | 4121  |
| Title      | Ground Floor<br>Layout<br>Licensing                           |